

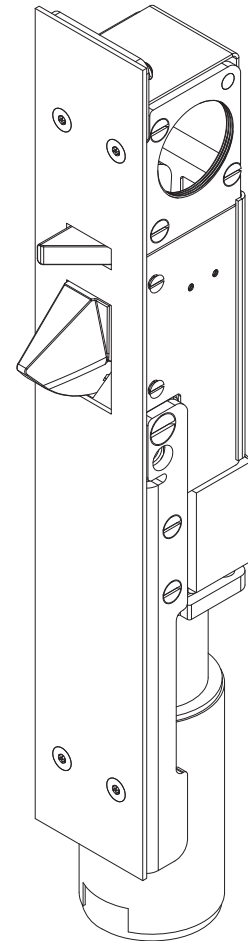

## WLS-1300 Narrow Jamb Motorized Deadlocking Latch w/ Key Cylinder



### Recommended Specifications

#### Application:

The WLS-1300 series latch is used in medium security applications including medium inmate confinement, Governmental and Industrial buildings. The WLS-1300 is normally jamb mounted in a steel door frame with a recommended minimum 14 gauge construction.

#### Standard lock shall include:

- Secure and impact resistant
- Latch has a full 3/4" latch throw
- High torque 24VDC motor or manual key unlock/relock
- 24VDC operation, .25-.5 amp @ 24VDC, 2 amp max draw
- Door jamb mounted
- Can withstand abnormally high side loads of up to 600lbs
- All internal parts including strike plate are machined stainless, cast stainless steel and other non-ferrous alloys
- Internal monitoring of deadlock status achieved through a direct contact with a lock status switch. The lock status switch must be used in conjunction with a door position switch. Use of an approved door position switch ensures that the door is closed & locked when a secure signal is sent to the control source
- Lock Status Switch and Motor Control Switches

#### Optional Features:

- KC - Key Cylinder (Standard Size)
- MC - Prison Mogul Cylinder
- LEK - Local Electronic Keyswitch

**To specify fixture and accessories, use the Model Number and Options page.**

Example: To specify a, Narrow Jamb Motorized Deadlocking Latch keyed one side, 24VDC, left hand reverse and factory installed key cylinder.

Use the following Willoughby Model Number:  
**WLS-1300-K1-LHR-KC**



**WARNING:** Cancer and Reproductive Harm

- [www.P65Warnings.ca.gov](http://www.P65Warnings.ca.gov)

visit our website at [www.willoughbylocks.com](http://www.willoughbylocks.com)  
5105 West 78th Street • Indianapolis, IN. 46268  
(317) 875-0830 • Fax: (317) 875-0837 • (800) 428-4065



MADE IN THE U.S.A.